



ATURE  
CONSERVATION  
is not just a front for us.

CAN BE APPLIED TO ANY SUBSTRATE

CAN BE COMBINED AND FILLED WITH ANY INSULATION MATERIAL

MAXIMUM PROTECTION WITH PROTECT PANEL

This façade is reusable, which means it not only reduces pollutants during disposal, but – above all – massively reduces the total volume of waste generated.

✉ [office@all-in-protect.at](mailto:office@all-in-protect.at)

🌐 [www.all-in-protect.at](http://www.all-in-protect.at)

1

# PLANNING



## ENERGY CERTIFICATE AND GRANTS

Our solution is more cost-effective than others. And thanks to better planning, you also **save a great deal of money**. We help you achieve the best possible energy rating and hence obtain the maximum amount of grants. We calculate and create:

- ENERGY CERTIFICATE
- EFFICIENCY PLAN
- ECOLOGICAL CONSTRUCTION PLANS



## PLANNING AND ANALYSIS PROTECT THE ENVIRONMENT

We analyse existing buildings with the help of thermography, and we plan new projects down to the finest detail. All components and connecting pieces are then produced precisely in accordance with **requirements**. We thereby avoid:

- SURPLUS MATERIALS
- STORAGE COSTS
- PRODUCTION WASTE



VISIT OUR WEBSITE



SUSTAINABLE

# RECYCLING



## 100% RECYCLABLE MATERIALS

We back a **real circular economy**. This means we focus on recyclable raw materials or on products that have been made from recycled materials.

Once your ALL-IN-PROTECT façade has reached the end of its above-average service life, the materials used can be easily recycled. The filling material is extracted, cleaned and can subsequently be reused for **decades to come**.

**60** YEAR  
QUALITY  
GUARANTEE\*



CONVENTIONAL  
FAÇADES ONLY  
LAST  
20 TO 30 YEARS

ALL-IN-PROTECT



Conventional façade



# PRODUCTION



## NATURAL RAW MATERIALS

- WOOD
- STONE
- PAPER
- WATER
- PLANT PARTS
- METAL

We use only **natural products** and **recyclable raw materials** for the production of our façade elements.



## REGIONAL VALUE CREATION

- GROWN HERE
- MADE HERE
- PROCESSED HERE

Most of our raw materials come from **Austria** and the rest from Europe. As well as **lowering transport costs**, this reduces our **environmental impact**.

Thanks to precise planning and use of suitable moulds, no production residues or other unnecessary waste is generated. We can simply recycle any surplus material.

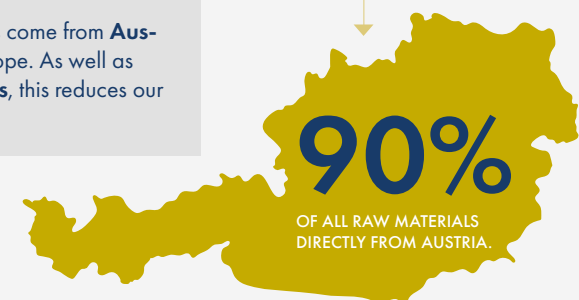

# PROCESSING



## PRODUCTION WITH VERY LITTLE WASTE

Often, **new building materials** are **thrown away** without ever being used.

With us, you avoid this waste and the associated costs. Thanks to its system components, the ALL-IN-PROTECT solution can deliver high-quality façades with practically no waste whatsoever.



## NATURAL INSULATION MATERIALS

To fill the façade on site, we use only **natural materials**:

- CELLULOSE
- MINERAL WOOL
- HEMP
- SHEEP'S WOOL
- STRAW

## EXAMPLE

For a thermal insulation composite system, up to 7% of the insulation material is wasted.

With the ALL-IN-PROTECT façade, this can be reduced to as little as 1%, representing a total waste reduction of around 95%.

ALL-IN-PROTECT



Conventional façade



UP TO

**95%**

LESS WASTE THAN A THERMAL INSULATION COMPOSITE SYSTEM FAÇADE

3

4



STANDS THE TEST OF TIME

# KEEP STRONG

**Public buildings** need a façade system that performs better than conventional solutions and withstands greater strains. The robust **outer shell of the ALL-IN-PROTECT panel** allows all the demanding requirements made in the public sector to be met.

For example, an appropriate façade structure can be planned and implemented to meet all the requirements for designs certified to **A2 fire safety standards** or for the desired **sound insulation**.

The surface created is particularly **robust and resilient**, so it offers **maximum protection** even in demanding circumstances. This makes ALL-IN-PROTECT the first choice for **municipal buildings, schools and designing other public buildings**.

IMPACT-RESISTANT AND DURABLE

CERTIFIED TO MEET HIGHEST STANDARDS

COST-EFFECTIVE DUE TO LONG SERVICE LIFE



MADE FOR HIGHLY CREATIVE SOLUTIONS

## WIDE RANGE

The ALL-IN-PROTECT façade system offers **architects and planners** unlimited creative **freedom**. With our system, **all common surfaces and PV systems and all types of design element** can be produced and implemented with little additional effort.

Thanks to the **high flexibility in terms of insulation thickness** and the interaction of different **system details**, almost **any idea is feasible**. Installations can be easily integrated into the insulation layer of the façade with millimetre precision.

Our solution also opens up **new possibilities**. The larger thermal mass **compared to conventional thermal insulation composite systems** offers **greater heat protection**. This is playing an increasingly important role in temperature regulation during summer, especially in urban areas. ALL-IN-PROTECT is designed to meet the **requirements of the future**, from façade greening through to innovative cooling systems and energy generation.

HIGH FLEXIBILITY

CREATIVE FREEDOM

PRECISE EXECUTION





WITH US, ENVIRONMENTAL PROTECTION IS NOT JUST A FRONT

# NATURAL

We create façades for **future generations**. We pay particular attention to **environmental compatibility and regional origin** from the production of the necessary materials onwards. We have reduced the amount of waste generated during construction to an absolute minimum. When filling with insulation material, we already manage to meet our ambitious target of **0% waste**.

All materials in an ALL-IN-PROTECT façade can be **recycled and reused**. The system designed for several generations thereby adapts ideally to any new requirements. **Building conversions or extensions** can be implemented easily, and there is no need for **expensive disposal**.

REGIONAL RAW MATERIALS

NO UNNECESSARY BY-PRODUCTS

FULLY RECYCLABLE

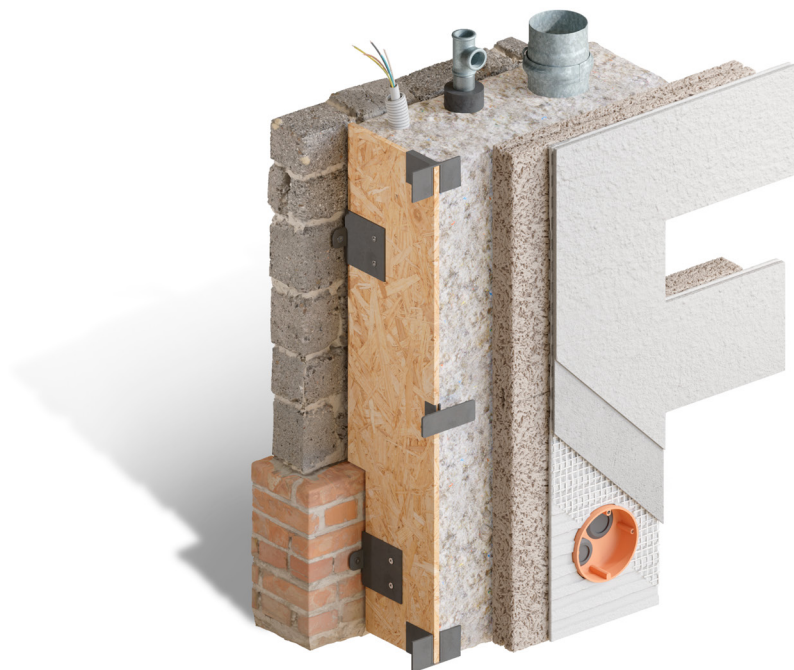

MOULDS ITSELF SEAMLESSLY TO ANY BUILDING

## FLEXIBLE

**Façade renewal** is often difficult, especially when it comes to old buildings. ALL-IN-PROTECT enables **easy thermal renovation** of old buildings, irrespective of the surface or how uneven it is. The system adapts to any substrate, whether brick, concrete or wood.

Good planning ensures that your renovations stand the test of time. Thanks to the **modular structure**, **large insulation thicknesses** can also be accommodated, and all common insulation materials can be integrated. Future insulation developments can be incorporated into the system without any problems. This means that **ecological insulation** with straw, wood fibre or sheep's wool during renovation is already much easier.

One of the main benefits of ALL-IN-PROTECT solutions is their **durability**. With a **pull-off test** on the existing substrate, we determine the required number of anchors and their dimensions during the planning stage. This guarantees the necessary permanence on all substrates. The hard Protect panel ensures **maximum protection** of the building. Even if extreme weather events become more frequent in future, hail and heavy rain will not harm the façade.

WORKS ON ALL SUBSTRATES

DELIVERS THE DESIRED INSULATION PERFORMANCE

OFFERS LASTING PROTECTION FOR ALL BUILDINGS

## OUR COMPANY

The company was founded in 2018 by three young, dynamic men. Their vision was to offer customers a sustainable, reusable (recyclable) and – above all – affordable façade.

## WHAT IS THE BASIS?

ALL-IN-PROTECT is a sustainable solution for the future, which not only meets the strict requirements of the new EU directives (reduction of greenhouse gases and CO<sub>2</sub> emissions), but also goes one step further: The innovative façade is reusable, which means it not only reduces pollutants during disposal, but – above all – massively reduces the total volume of waste generated. In addition, the structure can be applied to any substrate. This significantly reduces the effort involved in manufacturing the fastening material, which in turn also benefits the environment.

But for us, innovative not only means doing something good for nature and subsequent generations, we also want to create real added value for our customers.

# ALL IN PROTECT

✉ [office@all-in-protect.at](mailto:office@all-in-protect.at)  
🌐 [www.all-in-protect.at](http://www.all-in-protect.at)  
f @ [allinprotect](https://www.instagram.com/allinprotect)